

Any technical assistance or advice, incl. calculations and/or drawings, whether provided orally or in writing, that Holcim Solutions and Products EMEA BV ("Holcim") provides is based on latest knowledge and experiences and is done in good faith. It is meant to offer professional advice and information for the proper use of its products. Information is subject to change without notice. For latest and complete product and detail information, please refer to the technical information posted on www.holcimelevate.com. Under no circumstances, shall Holcim be construed as co-designer or co-builder of the finite set in which Holcim products or services have been used and such assistances or advice shall not be construed as a warranty of any kind. Customer also bears the responsibility to ensure the project system design and legal use of Elevate products need to comply with national regulations and law in force. The selection, intermediary storage, handling and the installation of the Elevate products by customer are beyond the control of Holcim and are, therefore, the sole responsibility of the customer. No Holcim representative is authorized to vary this disclaimer.

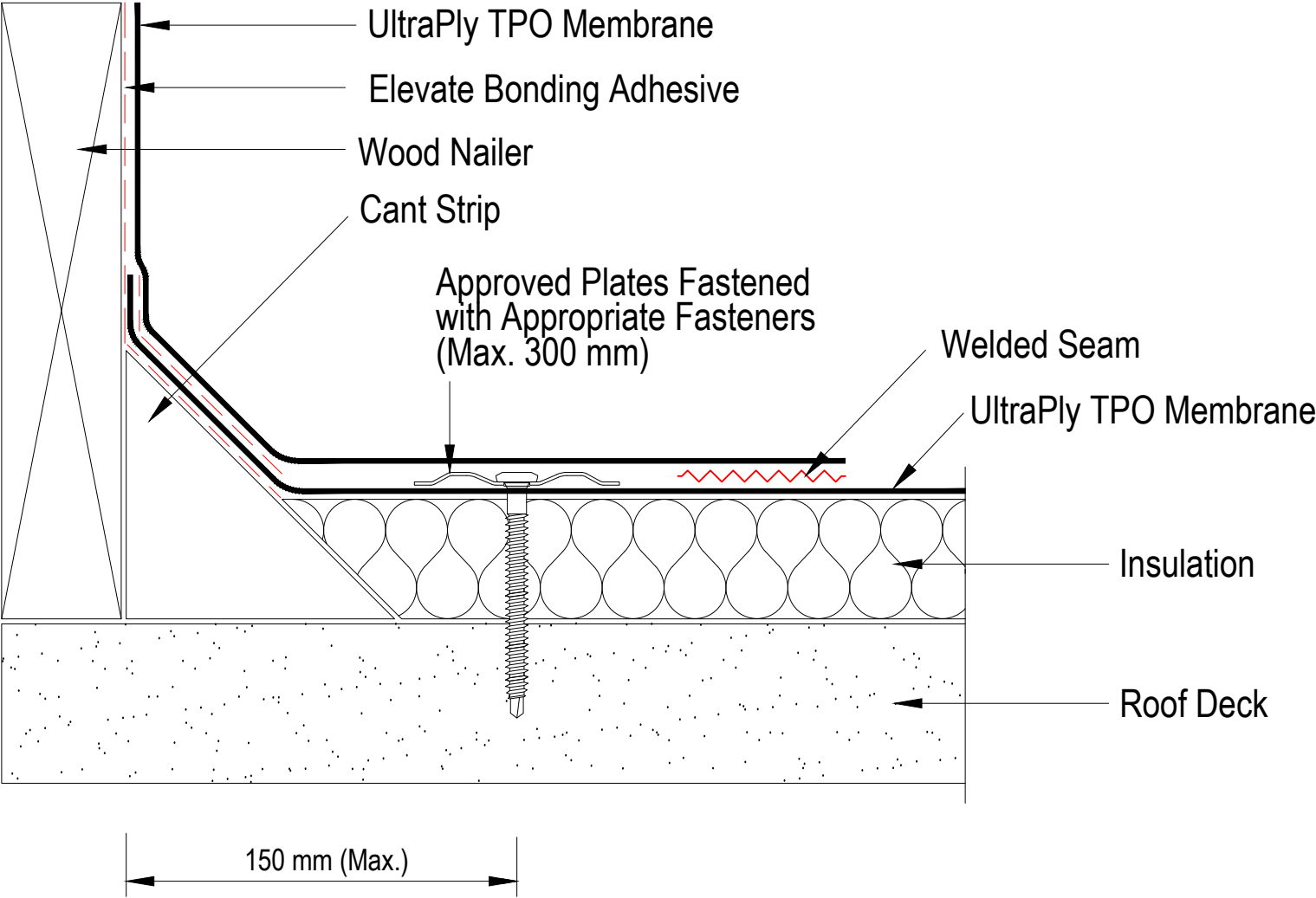

	UltraPly™ TPO	System All	UT - BT - 3
	Base Tie-In using plates at Upstand with Existing Cant	Not to scale	10/2022
			EMEA & Asia