

ARDEX WET AREA WATERPROOFING DRAWING LIST

DRAWING NO.	SHEET TITLE	DATE
AWW-00	DRAWING LIST	06.05.2019
AWW-01	TYPICAL PREFORMED SHOWER BASE WALL/FLOOR JUNCTION	06.05.2019
AWW-02	TYPICAL PREFORMED SHOWER BASE/FLOOR JUNCTION	06.05.2019
AWW-03	BATH/WALL JUNCTION - RECESSED	06.05.2019
AWW-04	BATH/WALL JUNCTION - BATTENED	06.05.2019
AWW-05	BATH WITH RIM	06.05.2019
AWW-06	BATH WITHOUT RIM	06.05.2019
AWW-07	TYPICAL DETAIL FOR RECESSED SOAP HOLDERS	06.05.2019
AWW-08	ENCLOSED SHOWER - MEMBRANE BELOW TILE BED	06.05.2019
AWW-09	UNENCLOSED SHOWER - MEMBRANE BELOW TILE BED	06.05.2019
AWW-10	UNENCLOSED SHOWER - MEMBRANE ABOVE TILE BED	06.05.2019
AWW-11	TYPICAL HOBLESS CONSTRUCTION	06.05.2019
AWW-12	BOND BREAKER - CLASS 3 MEMBRANE	06.05.2019
AWW-13	TYPICAL MEMBRANE TERMINATION AT DRAINAGE FLANGE	06.05.2019
AWW-14	WPM 750 CLAMP WASTE	06.05.2019
AWW-15	TYPICAL MEMBRANE TERMINATION AT DRAINAGE CHANNEL	06.05.2019
AWW-16	WET AREA VINYL DETAIL AT WASTE	06.05.2019
AWW-17	TILE TERMINATION AT DRAINAGE FLANGE WITH SOUNDPROOFING	06.05.2019
AWW-18	ENCLOSED SHOWER WITH HOB	06.05.2019
AWW-19	ENCLOSED SHOWER ON FLAT SUBSTRATE	06.05.2019
AWW-20	NO SHOWER PANEL	06.05.2019
AWW-21	WALL/FLOOR DETAIL	06.05.2019
AWW-22	TILED FLOOR SOUNDPROOFING WITH WATERPROOFING	06.05.2019
AWW-23	TYPICAL SHOWER HEAD OR FLEXIBLE HOSE CONNECTION	12.07.2022
AWW-24	TYPICAL SHOWER MIXER USING PROPRIETARY SYSTEM	12.07.2022
AWW-25	TYPICAL SHOWER MIXER USING SEALANT	12.07.2022

WET AREA WATERPROOFING

Disclaimer: Ardex makes every reasonable effort to ensure that the technical details, recommendations and other information contained in this drawing are accurate and represent our knowledge and experience at the time of design and publication. Ardex reserves the right to change the information without prior notice. Ardex provides the information in good faith with no representations or warranties (whether implied or otherwise), and will not be liable for any losses or damages (whether direct, indirect or consequential) whatsoever, whether in contract, negligence or any other action, arising out of or in connection with the use, or inability to use, the information. It is your responsibility to ensure that our products are used only for the purposes for which they are intended and are used in accordance with any applicable specifications, guidelines, standards, codes of practice, regulations and laws. The supply of our products and services are also subject to certain terms, warranties and exclusions which are available on request.

DRAWING LIST

SHEET TITLE

DWG NO.

AWW-00

DATE

06.05.2019

SCALE

@ A4



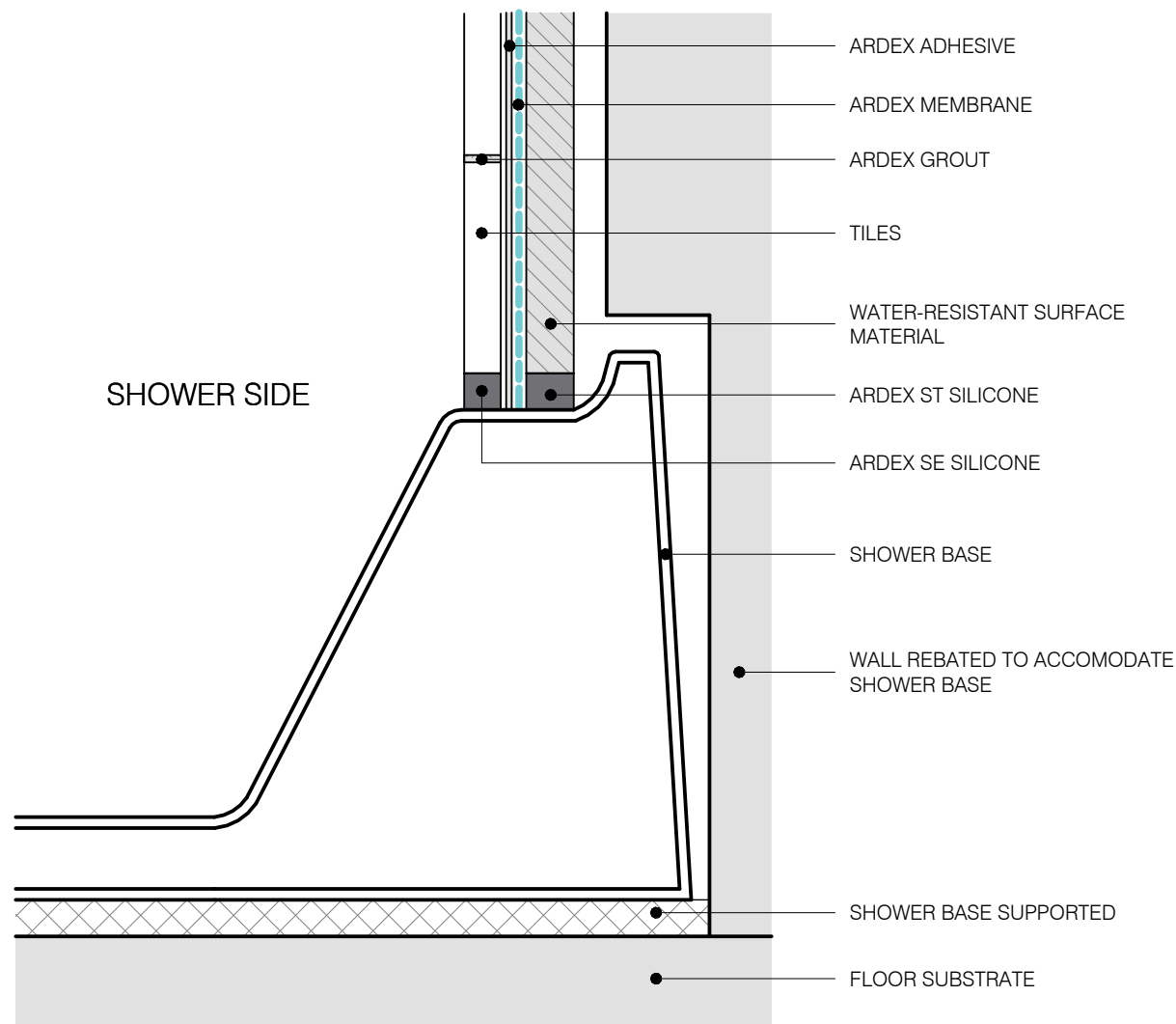

WET AREA WATERPROOFING

Disclaimer: Ardex makes every reasonable effort to ensure that the technical details, recommendations and other information contained in this drawing are accurate and represent our knowledge and experience at the time of design and publication. Ardex reserves the right to change the information without prior notice. Ardex provides the information in good faith with no representations or warranties (whether implied or otherwise), and will not be liable for any losses or damages (whether direct, indirect or consequential) whatsoever, whether in contract, negligence or any other action, arising out of or in connection with the use, or inability to use, the information. It is your responsibility to ensure that our products are used only for the purposes for which they are intended and are used in accordance with any applicable specifications, guidelines, standards, codes of practice, regulations and laws. The supply of our products and services are also subject to certain terms, warranties and exclusions which are available on request.

TYPICAL PREFORMED SHOWER BASE WALL/FLOOR JUNCTION

SHEET TITLE

DWG NO.

AWW-01

DATE

06.05.2019

SCALE

1 : 2 @ A4



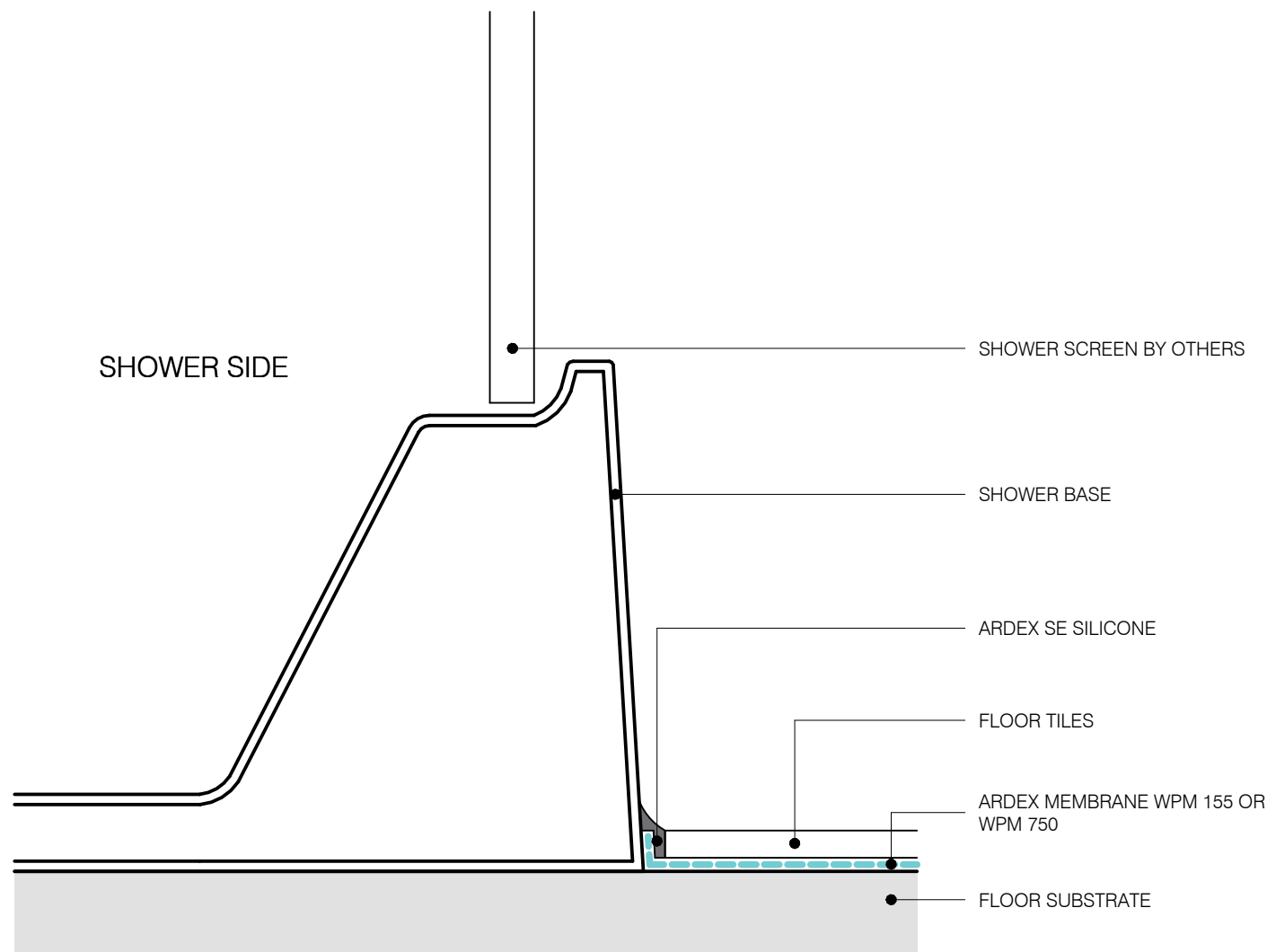

WET AREA WATERPROOFING

Disclaimer: Ardex makes every reasonable effort to ensure that the technical details, recommendations and other information contained in this drawing are accurate and represent our knowledge and experience at the time of design and publication. Ardex reserves the right to change the information without prior notice. Ardex provides the information in good faith with no representations or warranties (whether implied or otherwise), and will not be liable for any losses or damages (whether direct, indirect or consequential) whatsoever, whether in contract, negligence or any other action, arising out of or in connection with the use, or inability to use, the information. It is your responsibility to ensure that our products are used only for the purposes for which they are intended and are used in accordance with any applicable specifications, guidelines, standards, codes of practice, regulations and laws. The supply of our products and services are also subject to certain terms, warranties and exclusions which are available on request.

TYPICAL PREFORMED SHOWER BASE/FLOOR JUNCTION

SHEET TITLE

DWG NO.

AWW-02

DATE

06.05.2019

SCALE

1 : 2 @ A4



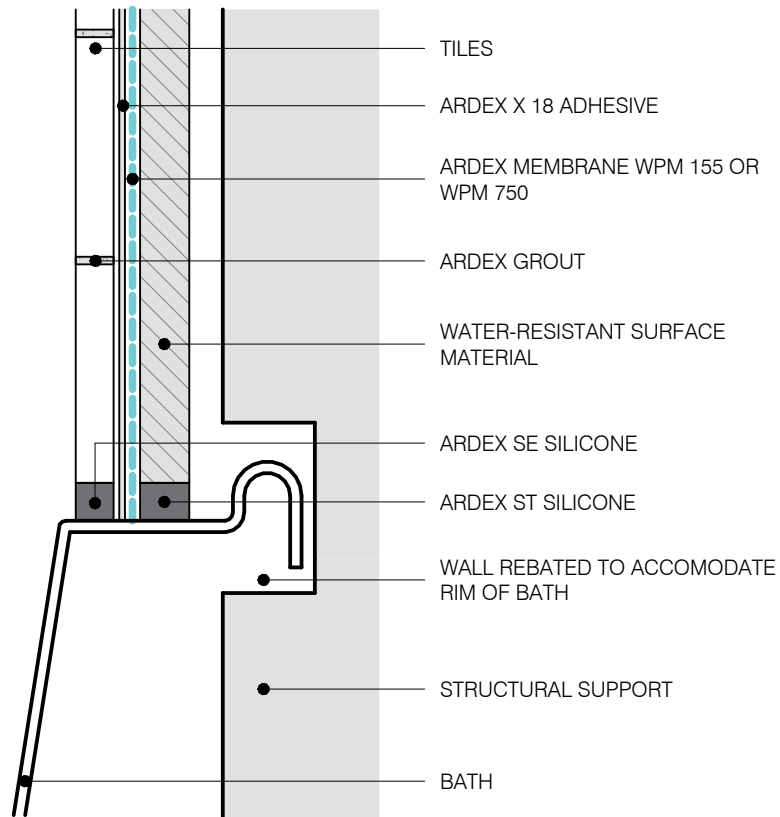

WET AREA WATERPROOFING

Disclaimer: Ardex makes every reasonable effort to ensure that the technical details, recommendations and other information contained in this drawing are accurate and represent our knowledge and experience at the time of design and publication. Ardex reserves the right to change the information without prior notice. Ardex provides the information in good faith with no representations or warranties (whether implied or otherwise), and will not be liable for any losses or damages (whether direct, indirect or consequential) whatsoever, whether in contract, negligence or any other action, arising out of or in connection with the use, or inability to use, the information. It is your responsibility to ensure that our products are used only for the purposes for which they are intended and are used in accordance with any applicable specifications, guidelines, standards, codes of practice, regulations and laws. The supply of our products and services are also subject to certain terms, warranties and exclusions which are available on request.

BATH/WALL JUNCTION - RECESSED

SHEET TITLE

DWG NO. **AWW-03**

DATE 06.05.2019

SCALE 1 : 2 @ A4



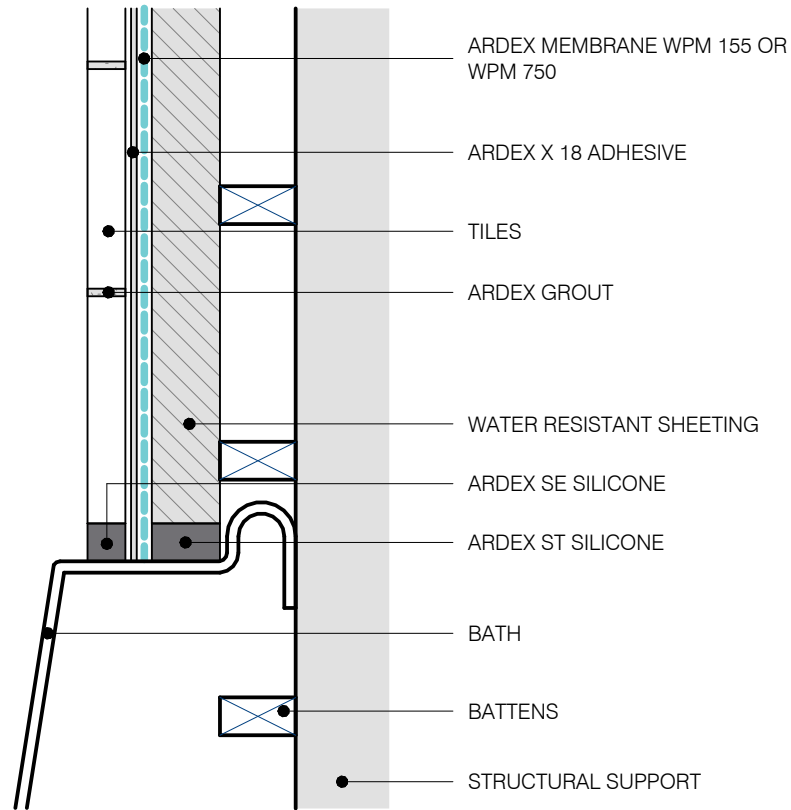

WET AREA WATERPROOFING

Disclaimer: Ardex makes every reasonable effort to ensure that the technical details, recommendations and other information contained in this drawing are accurate and represent our knowledge and experience at the time of design and publication. Ardex reserves the right to change the information without prior notice. Ardex provides the information in good faith with no representations or warranties (whether implied or otherwise), and will not be liable for any losses or damages (whether direct, indirect or consequential) whatsoever, whether in contract, negligence or any other action, arising out of or in connection with the use, or inability to use, the information. It is your responsibility to ensure that our products are used only for the purposes for which they are intended and are used in accordance with any applicable specifications, guidelines, standards, codes of practice, regulations and laws. The supply of our products and services are also subject to certain terms, warranties and exclusions which are available on request.

BATH/WALL JUNCTION - BATTENED

SHEET TITLE

DWG NO. **AWW-04**

DATE 06.05.2019

SCALE 1 : 2 @ A4



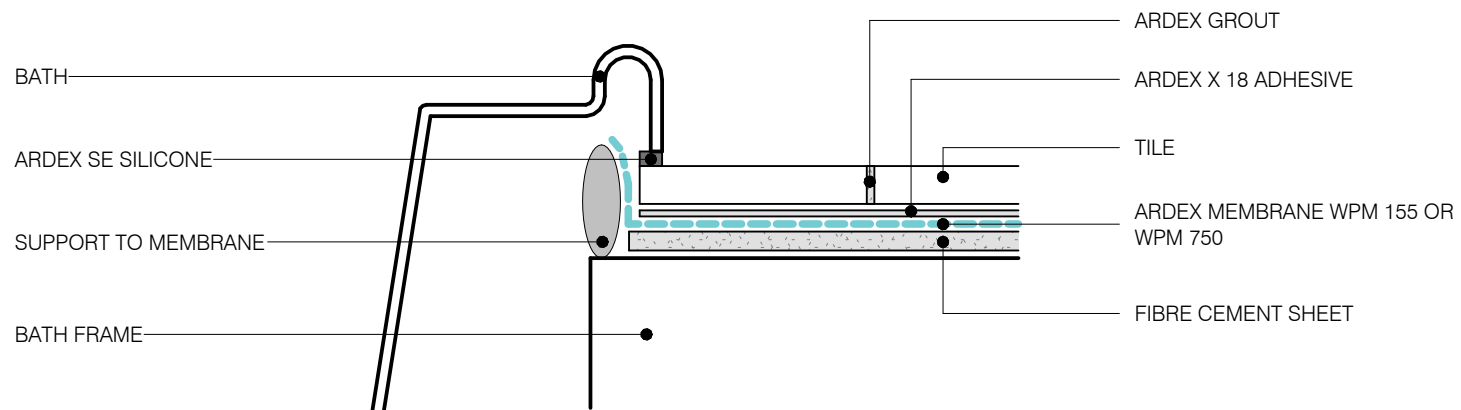

WET AREA WATERPROOFING

Disclaimer: Ardex makes every reasonable effort to ensure that the technical details, recommendations and other information contained in this drawing are accurate and represent our knowledge and experience at the time of design and publication. Ardex reserves the right to change the information without prior notice. Ardex provides the information in good faith with no representations or warranties (whether implied or otherwise), and will not be liable for any losses or damages (whether direct, indirect or consequential) whatsoever, whether in contract, negligence or any other action, arising out of or in connection with the use, or inability to use, the information. It is your responsibility to ensure that our products are used only for the purposes for which they are intended and are used in accordance with any applicable specifications, guidelines, standards, codes of practice, regulations and laws. The supply of our products and services are also subject to certain terms, warranties and exclusions which are available on request.

BATH WITH RIM
SHEET TITLE

DWG NO.	AWW-05
DATE	06.05.2019
SCALE	1 : 2 @ A4



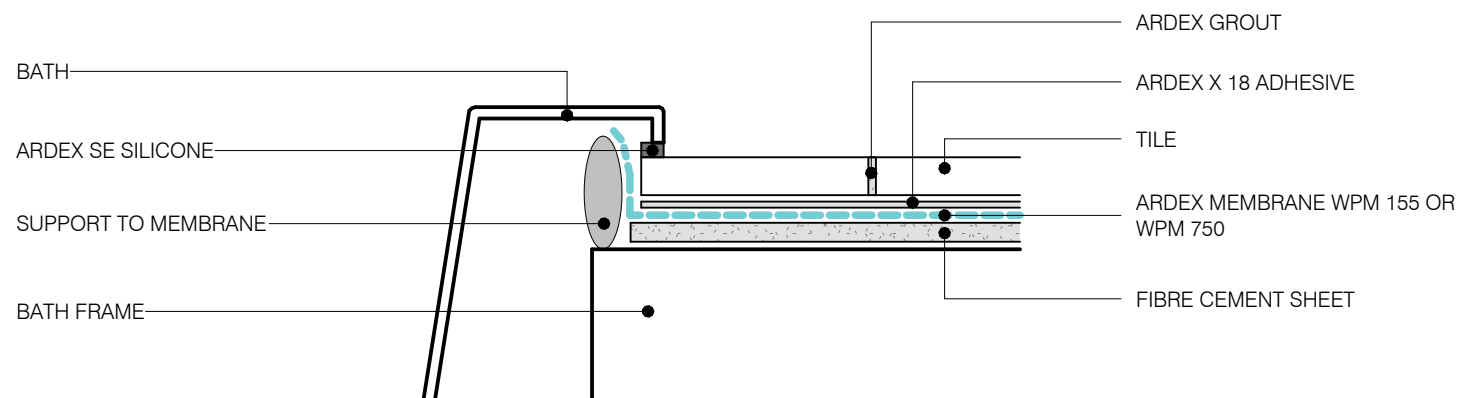

WET AREA WATERPROOFING

Disclaimer: Ardex makes every reasonable effort to ensure that the technical details, recommendations and other information contained in this drawing are accurate and represent our knowledge and experience at the time of design and publication. Ardex reserves the right to change the information without prior notice. Ardex provides the information in good faith with no representations or warranties (whether implied or otherwise), and will not be liable for any losses or damages (whether direct, indirect or consequential) whatsoever, whether in contract, negligence or any other action, arising out of or in connection with the use, or inability to use, the information. It is your responsibility to ensure that our products are used only for the purposes for which they are intended and are used in accordance with any applicable specifications, guidelines, standards, codes of practice, regulations and laws. The supply of our products and services are also subject to certain terms, warranties and exclusions which are available on request.

BATH WITHOUT RIM
SHEET TITLE

DWG NO. **AWW-06**

DATE 06.05.2019

SCALE 1 : 2 @ A4



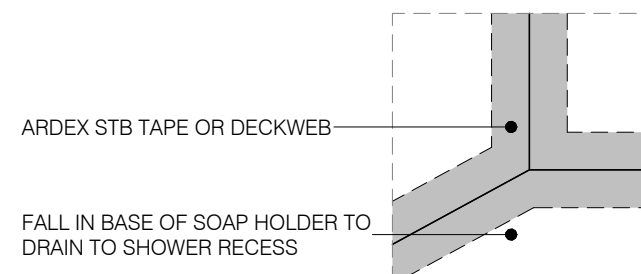
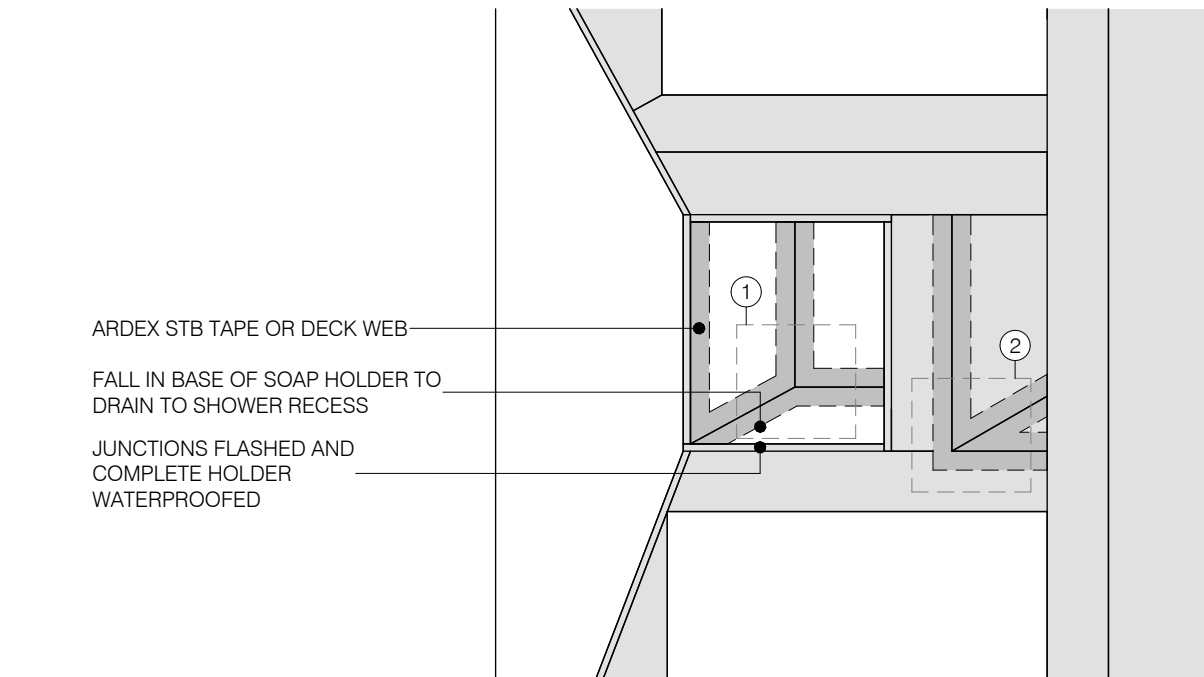

CALLOUT ①

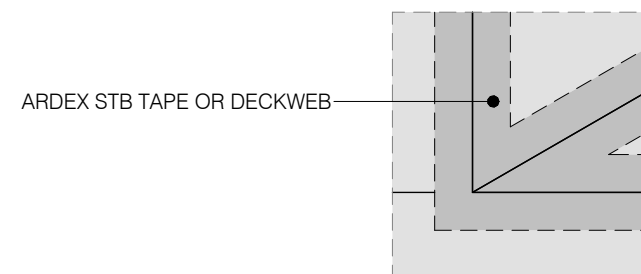

CALLOUT ②

WET AREA WATERPROOFING

Disclaimer: Ardex makes every reasonable effort to ensure that the technical details, recommendations and other information contained in this drawing are accurate and represent our knowledge and experience at the time of design and publication. Ardex reserves the right to change the information without prior notice. Ardex provides the information in good faith with no representations or warranties (whether implied or otherwise), and will not be liable for any losses or damages (whether direct, indirect or consequential) whatsoever, whether in contract, negligence or any other action, arising out of or in connection with the use, or inability to use, the information. It is your responsibility to ensure that our products are used only for the purposes for which they are intended and are used in accordance with any applicable specifications, guidelines, standards, codes of practice, regulations and laws. The supply of our products and services are also subject to certain terms, warranties and exclusions which are available on request.

TYPICAL DETAIL FOR RECESSED SOAP HOLDERS

SHEET TITLE

DWG NO. **AWW-07**

DATE 06.05.2019

SCALE As indicated



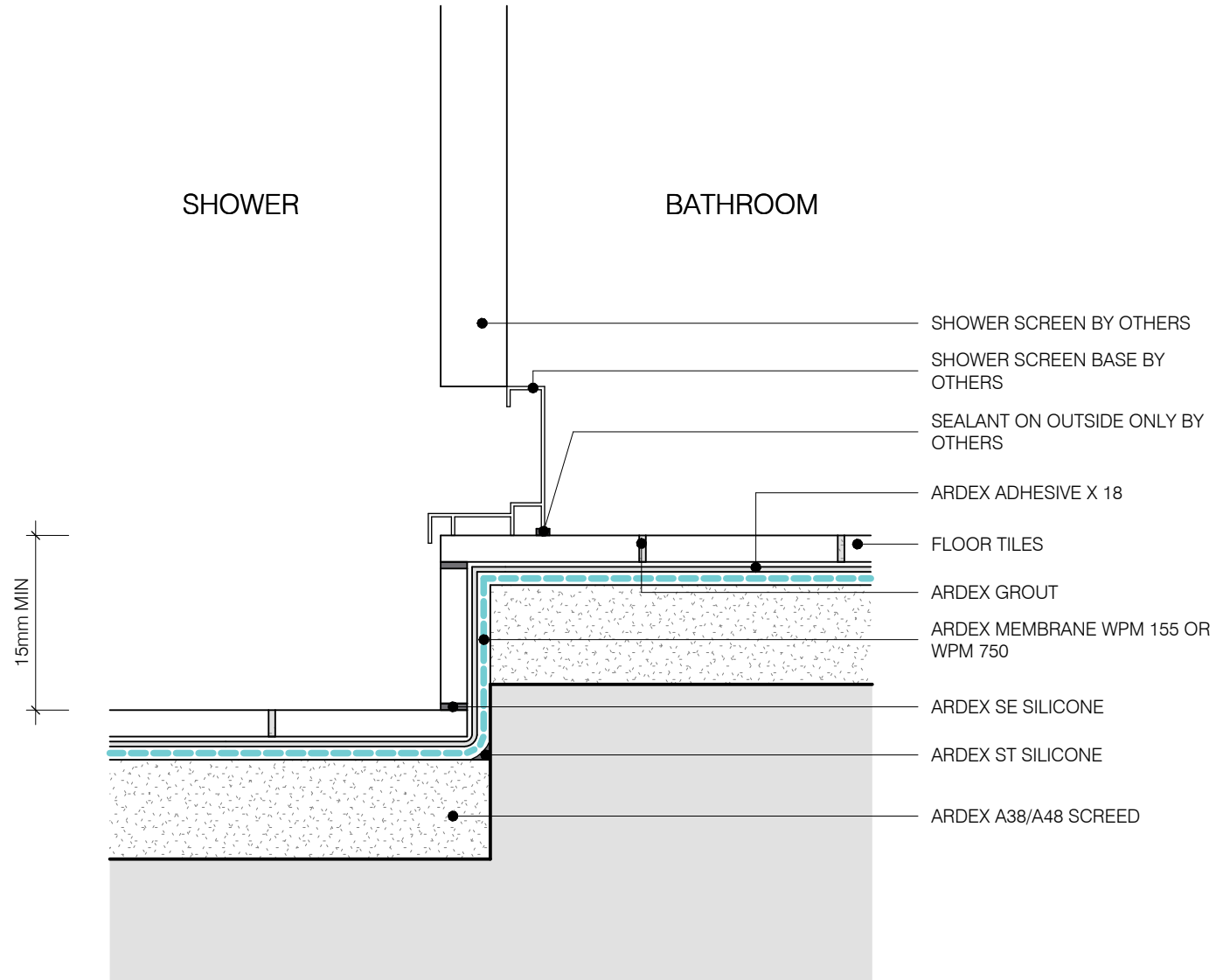

WET AREA WATERPROOFING

Disclaimer: Ardex makes every reasonable effort to ensure that the technical details, recommendations and other information contained in this drawing are accurate and represent our knowledge and experience at the time of design and publication. Ardex reserves the right to change the information without prior notice. Ardex provides the information in good faith with no representations or warranties (whether implied or otherwise), and will not be liable for any losses or damages (whether direct, indirect or consequential) whatsoever, whether in contract, negligence or any other action, arising out of or in connection with the use, or inability to use, the information. It is your responsibility to ensure that our products are used only for the purposes for which they are intended and are used in accordance with any applicable specifications, guidelines, standards, codes of practice, regulations and laws. The supply of our products and services are also subject to certain terms, warranties and exclusions which are available on request.

ENCLOSED SHOWER - MEMBRANE BELOW TILE BED

SHEET TITLE

DWG NO.

AWW-08

DATE

06.05.2019

SCALE

1 : 2 @ A4



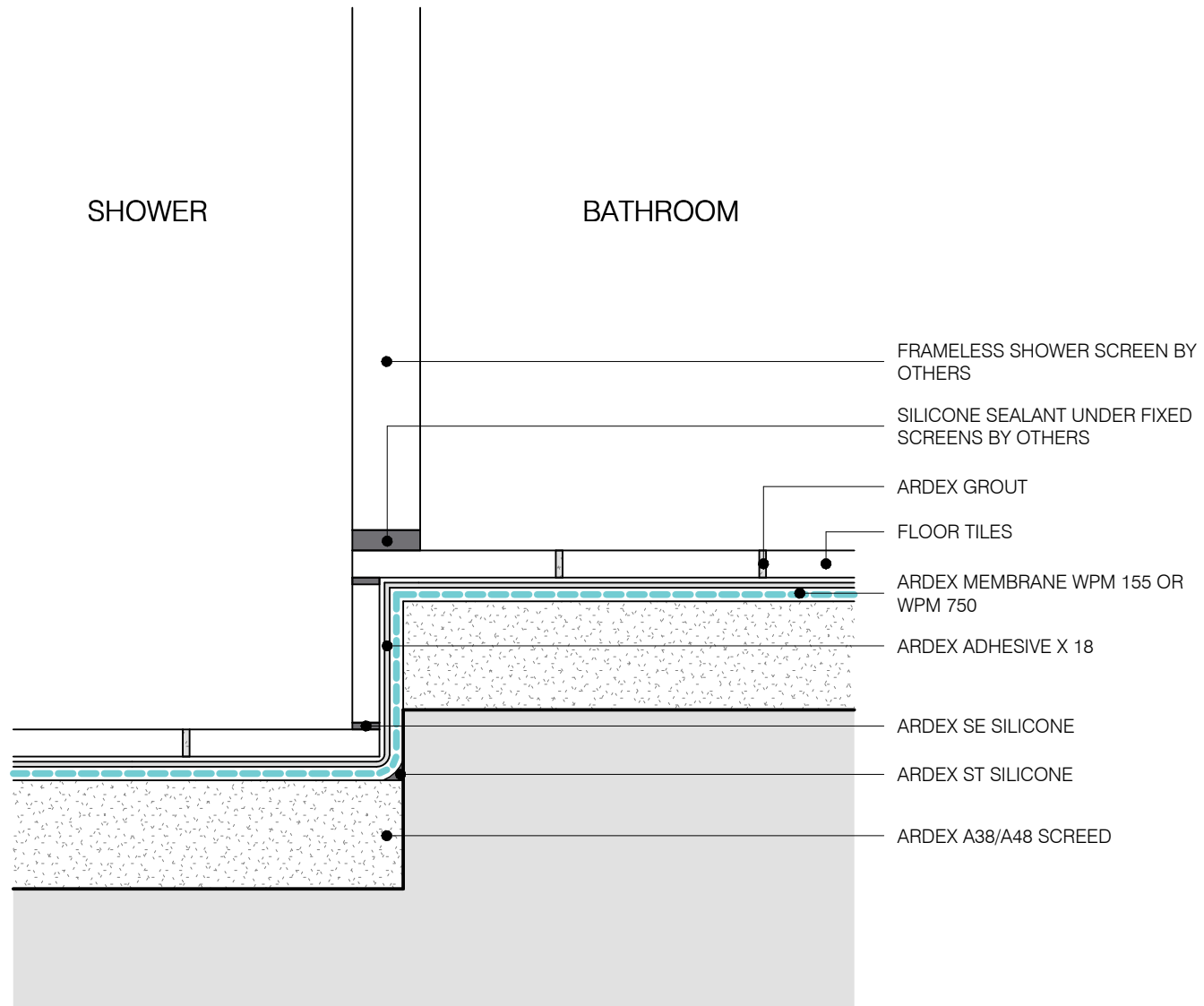

WET AREA WATERPROOFING

Disclaimer: Ardex makes every reasonable effort to ensure that the technical details, recommendations and other information contained in this drawing are accurate and represent our knowledge and experience at the time of design and publication. Ardex reserves the right to change the information without prior notice. Ardex provides the information in good faith with no representations or warranties (whether implied or otherwise), and will not be liable for any losses or damages (whether direct, indirect or consequential) whatsoever, whether in contract, negligence or any other action, arising out of or in connection with the use, or inability to use, the information. It is your responsibility to ensure that our products are used only for the purposes for which they are intended and are used in accordance with any applicable specifications, guidelines, standards, codes of practice, regulations and laws. The supply of our products and services are also subject to certain terms, warranties and exclusions which are available on request.

UNENCLOSED SHOWER - MEMBRANE BELOW TILE BED

SHEET TITLE

DWG NO. **AWW-09**

DATE 06.05.2019

SCALE 1 : 2 @ A4



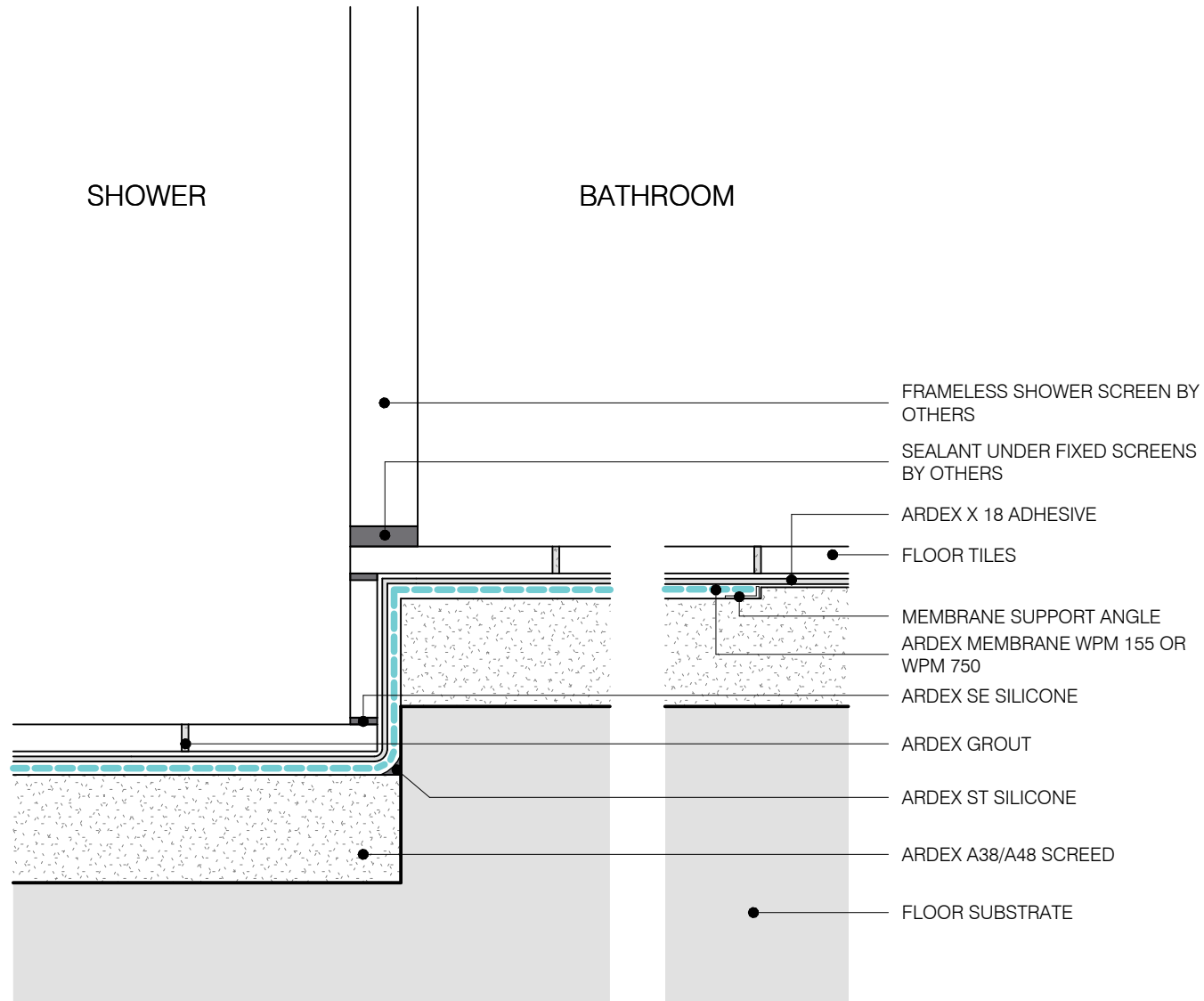

WET AREA WATERPROOFING

Disclaimer: Ardex makes every reasonable effort to ensure that the technical details, recommendations and other information contained in this drawing are accurate and represent our knowledge and experience at the time of design and publication. Ardex reserves the right to change the information without prior notice. Ardex provides the information in good faith with no representations or warranties (whether implied or otherwise), and will not be liable for any losses or damages (whether direct, indirect or consequential) whatsoever, whether in contract, negligence or any other action, arising out of or in connection with the use, or inability to use, the information. It is your responsibility to ensure that our products are used only for the purposes for which they are intended and are used in accordance with any applicable specifications, guidelines, standards, codes of practice, regulations and laws. The supply of our products and services are also subject to certain terms, warranties and exclusions which are available on request.

UNENCLOSED SHOWER - MEMBRANE ABOVE TILE BED

SHEET TITLE

DWG NO. **AWW-10**

DATE 06.05.2019

SCALE 1 : 2 @ A4



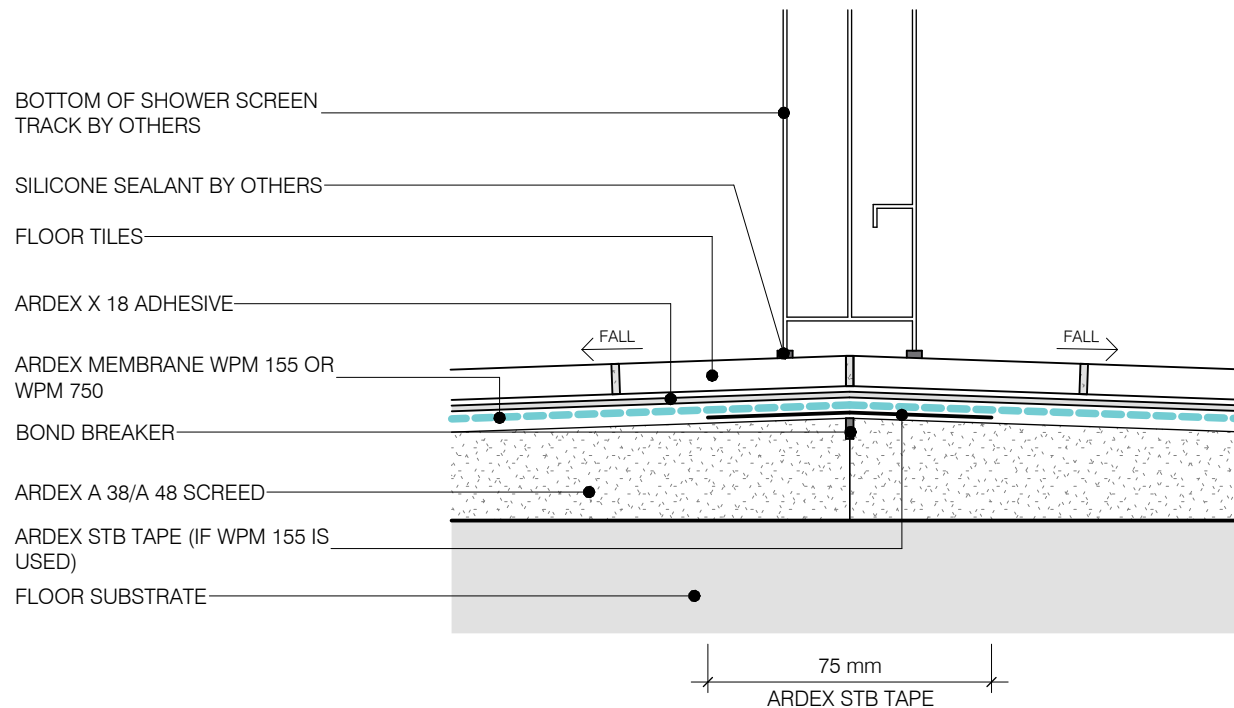

WET AREA WATERPROOFING

Disclaimer: Ardex makes every reasonable effort to ensure that the technical details, recommendations and other information contained in this drawing are accurate and represent our knowledge and experience at the time of design and publication. Ardex reserves the right to change the information without prior notice. Ardex provides the information in good faith with no representations or warranties (whether implied or otherwise), and will not be liable for any losses or damages (whether direct, indirect or consequential) whatsoever, whether in contract, negligence or any other action, arising out of or in connection with the use, or inability to use, the information. It is your responsibility to ensure that our products are used only for the purposes for which they are intended and are used in accordance with any applicable specifications, guidelines, standards, codes of practice, regulations and laws. The supply of our products and services are also subject to certain terms, warranties and exclusions which are available on request.

TYPICAL HOBLESS CONSTRUCTION

SHEET TITLE

DWG NO. **AWW-11**

DATE 06.05.2019

SCALE 1 : 2 @ A4



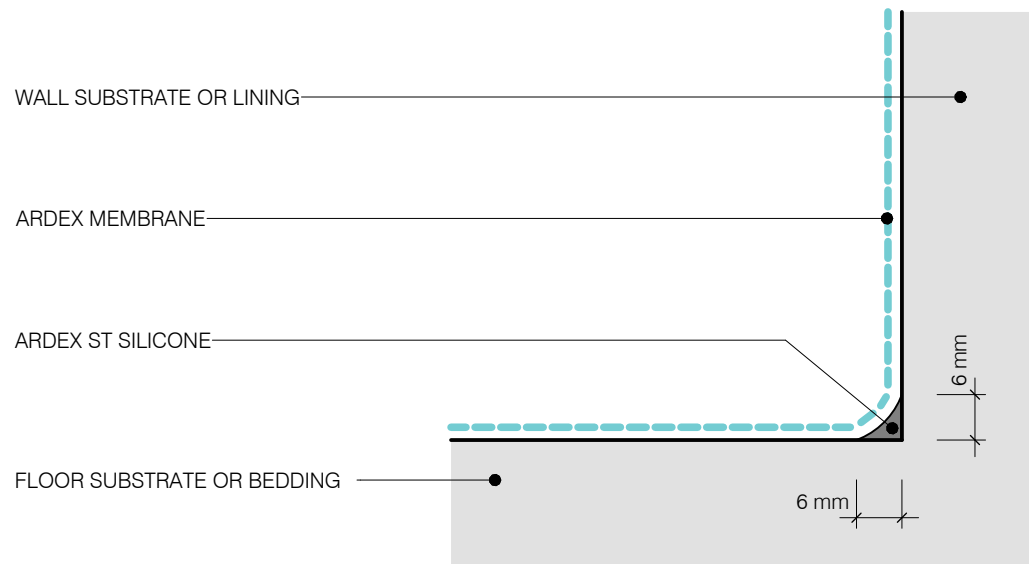

WET AREA WATERPROOFING

Disclaimer: Ardex makes every reasonable effort to ensure that the technical details, recommendations and other information contained in this drawing are accurate and represent our knowledge and experience at the time of design and publication. Ardex reserves the right to change the information without prior notice. Ardex provides the information in good faith with no representations or warranties (whether implied or otherwise), and will not be liable for any losses or damages (whether direct, indirect or consequential) whatsoever, whether in contract, negligence or any other action, arising out of or in connection with the use, or inability to use, the information. It is your responsibility to ensure that our products are used only for the purposes for which they are intended and are used in accordance with any applicable specifications, guidelines, standards, codes of practice, regulations and laws. The supply of our products and services are also subject to certain terms, warranties and exclusions which are available on request.

BOND BREAKER - CLASS 3 MEMBRANE

SHEET TITLE

DWG NO.	AWW-12
DATE	06.05.2019
SCALE	1 : 1 @ A4



NOTE:
FLANGE PREPARED USING
PLUMBERS CEMENT

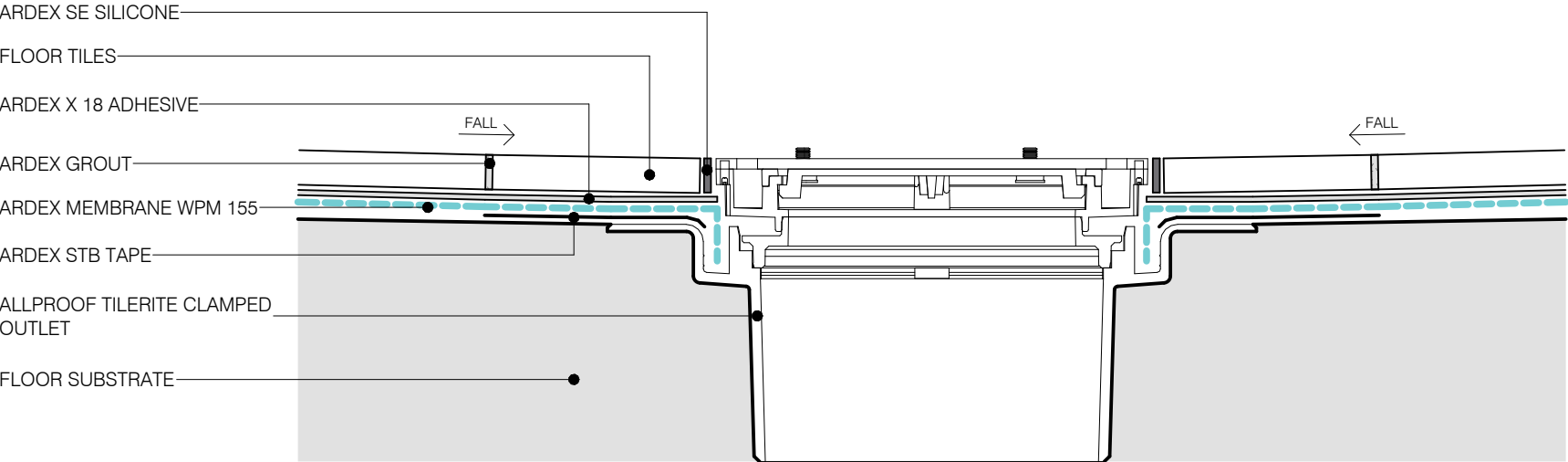

WET AREA WATERPROOFING

Disclaimer: Ardex makes every reasonable effort to ensure that the technical details, recommendations and other information contained in this drawing are accurate and represent our knowledge and experience at the time of design and publication. Ardex reserves the right to change the information without prior notice. Ardex provides the information in good faith with no representations or warranties (whether implied or otherwise), and will not be liable for any losses or damages (whether direct, indirect or consequential) whatsoever, whether in contract, negligence or any other action, arising out of or in connection with the use, or inability to use, the information. It is your responsibility to ensure that our products are used only for the purposes for which they are intended and are used in accordance with any applicable specifications, guidelines, standards, codes of practice, regulations and laws. The supply of our products and services are also subject to certain terms, warranties and exclusions which are available on request.

TYPICAL MEMBRANE TERMINATION AT DRAINAGE FLANGE

SHEET TITLE

DWG NO. **AWW-13**
DATE 06.05.2019
SCALE 1 : 2 @ A4



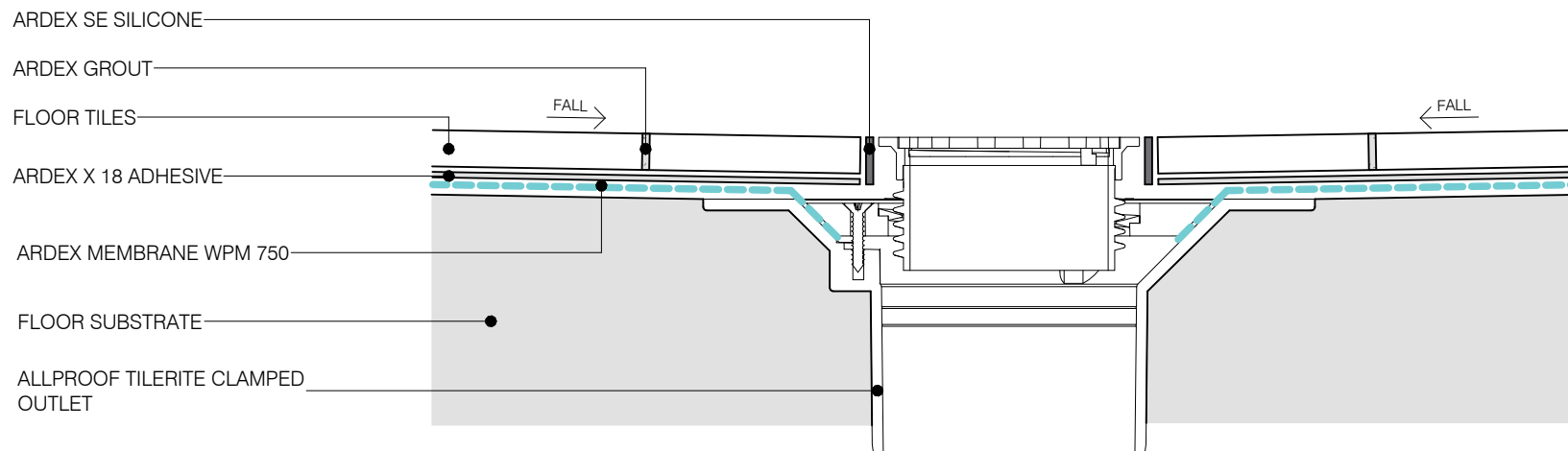

WET AREA WATERPROOFING

Disclaimer: Ardex makes every reasonable effort to ensure that the technical details, recommendations and other information contained in this drawing are accurate and represent our knowledge and experience at the time of design and publication. Ardex reserves the right to change the information without prior notice. Ardex provides the information in good faith with no representations or warranties (whether implied or otherwise), and will not be liable for any losses or damages (whether direct, indirect or consequential) whatsoever, whether in contract, negligence or any other action, arising out of or in connection with the use, or inability to use, the information. It is your responsibility to ensure that our products are used only for the purposes for which they are intended and are used in accordance with any applicable specifications, guidelines, standards, codes of practice, regulations and laws. The supply of our products and services are also subject to certain terms, warranties and exclusions which are available on request.

WPM 750 CLAMP WASTE
SHEET TITLE

DWG NO.	AWW-14
DATE	06.05.2019
SCALE	1 : 2 @ A4



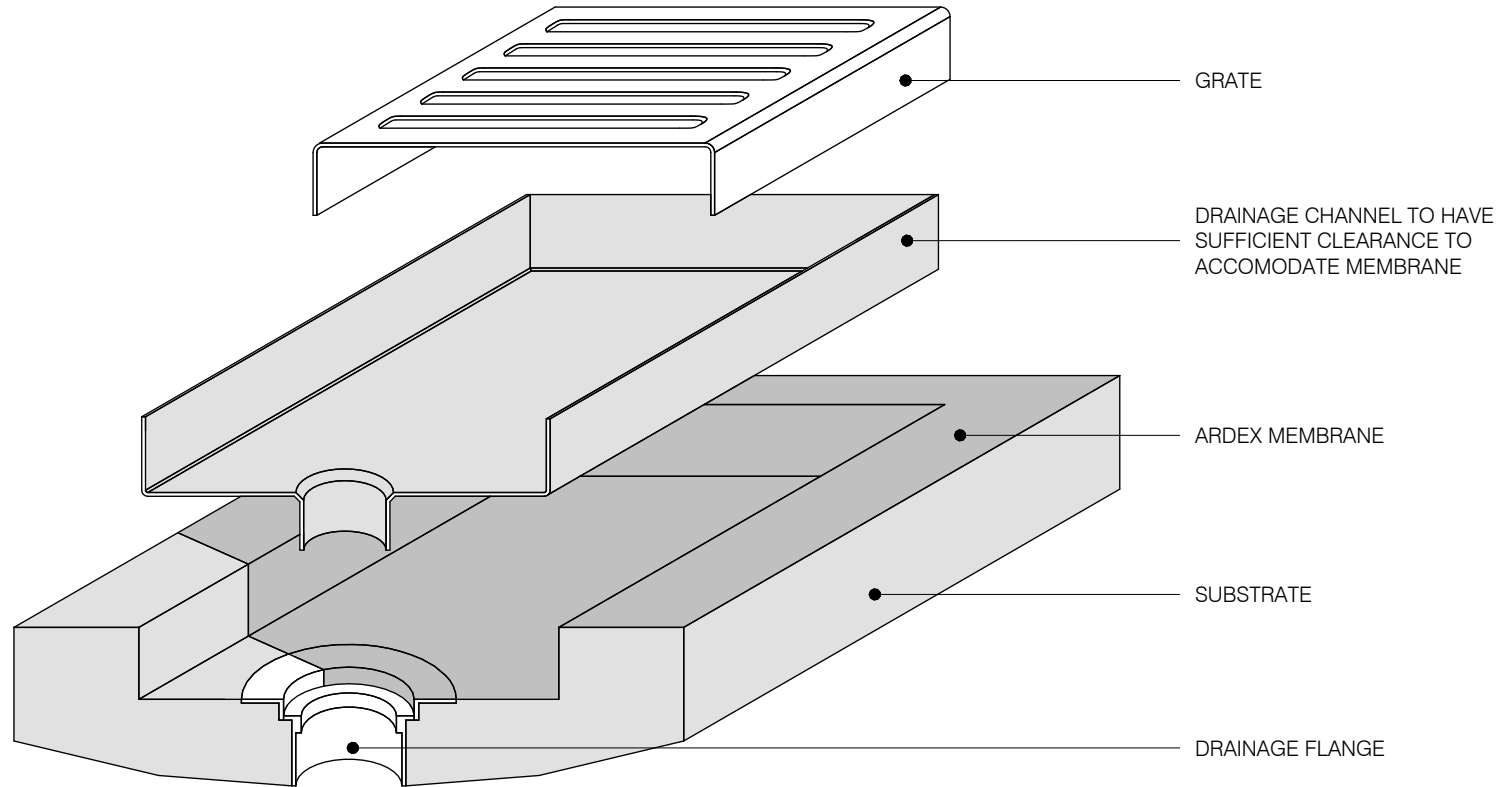

WET AREA WATERPROOFING

Disclaimer: Ardex makes every reasonable effort to ensure that the technical details, recommendations and other information contained in this drawing are accurate and represent our knowledge and experience at the time of design and publication. Ardex reserves the right to change the information without prior notice. Ardex provides the information in good faith with no representations or warranties (whether implied or otherwise), and will not be liable for any losses or damages (whether direct, indirect or consequential) whatsoever, whether in contract, negligence or any other action, arising out of or in connection with the use, or inability to use, the information. It is your responsibility to ensure that our products are used only for the purposes for which they are intended and are used in accordance with any applicable specifications, guidelines, standards, codes of practice, regulations and laws. The supply of our products and services are also subject to certain terms, warranties and exclusions which are available on request.

TYPICAL MEMBRANE TERMINATION AT DRAINAGE CHANNEL

SHEET TITLE

DWG NO.

AWW-15

DATE

06.05.2019

SCALE

1 : 2 @ A4



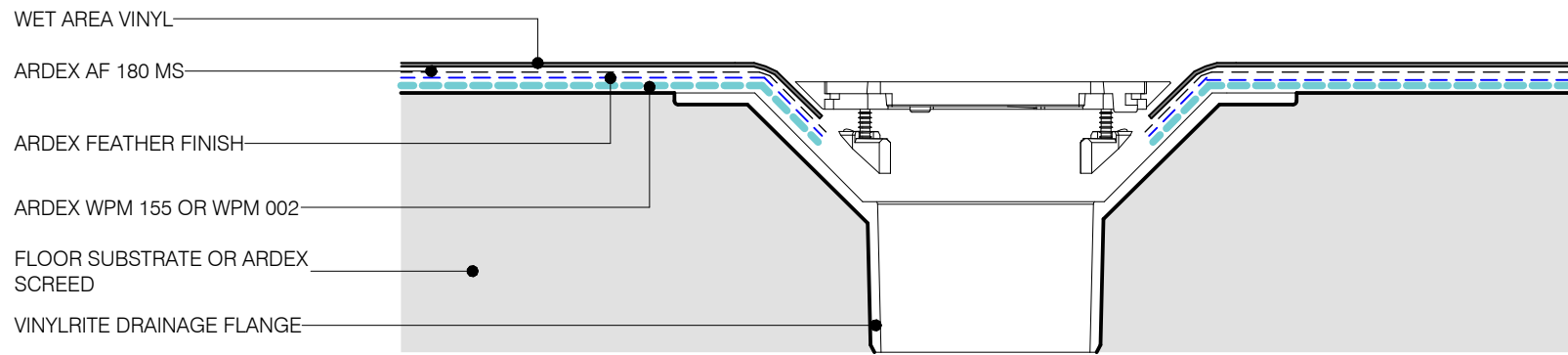

WET AREA WATERPROOFING

Disclaimer: Ardex makes every reasonable effort to ensure that the technical details, recommendations and other information contained in this drawing are accurate and represent our knowledge and experience at the time of design and publication. Ardex reserves the right to change the information without prior notice. Ardex provides the information in good faith with no representations or warranties (whether implied or otherwise), and will not be liable for any losses or damages (whether direct, indirect or consequential) whatsoever, whether in contract, negligence or any other action, arising out of or in connection with the use, or inability to use, the information. It is your responsibility to ensure that our products are used only for the purposes for which they are intended and are used in accordance with any applicable specifications, guidelines, standards, codes of practice, regulations and laws. The supply of our products and services are also subject to certain terms, warranties and exclusions which are available on request.

WET AREA VINYL DETAIL AT WASTE

SHEET TITLE

DWG NO. **AWW-16**

DATE 06.05.2019

SCALE 1 : 2 @ A4



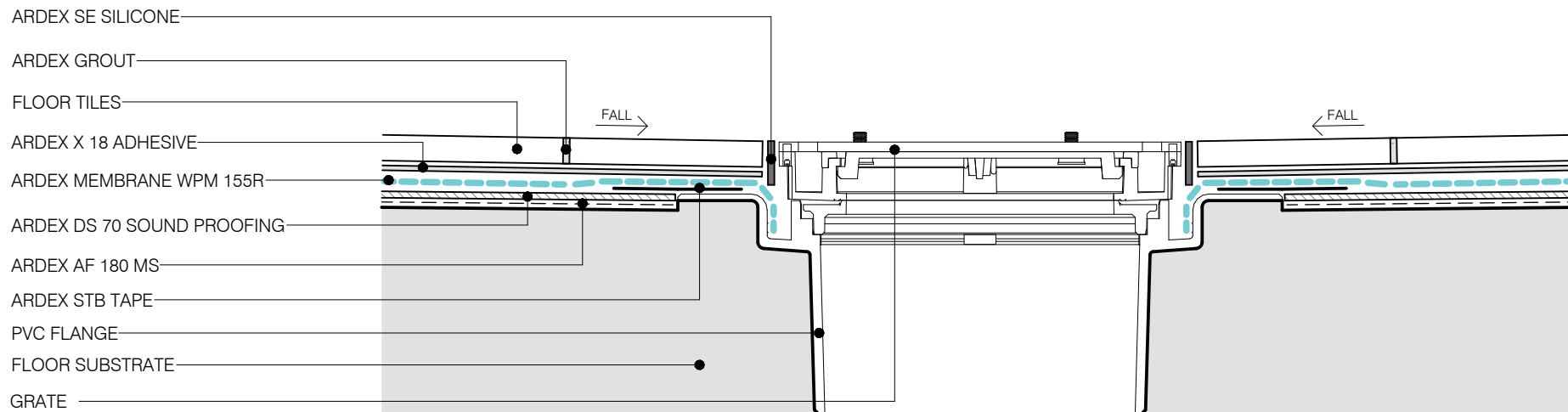

OPTION 1: ARDEX MEMBRANE WPM 155R

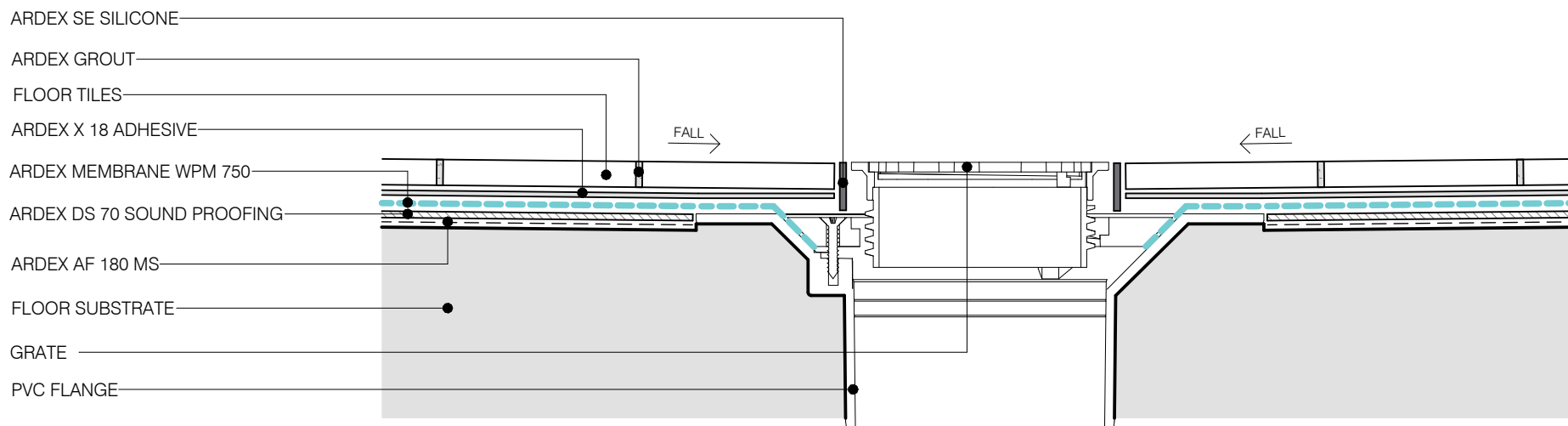

OPTION 2: ARDEX MEMBRANE WPM 750

WET AREA WATERPROOFING

Disclaimer: Ardex makes every reasonable effort to ensure that the technical details, recommendations and other information contained in this drawing are accurate and represent our knowledge and experience at the time of design and publication. Ardex reserves the right to change the information without prior notice. Ardex provides the information in good faith with no representations or warranties (whether implied or otherwise), and will not be liable for any losses or damages (whether direct, indirect or consequential) whatsoever, whether in contract, negligence or any other action, arising out of or in connection with the use, or inability to use, the information. It is your responsibility to ensure that our products are used only for the purposes for which they are intended and are used in accordance with any applicable specifications, guidelines, standards, codes of practice, regulations and laws. The supply of our products and services are also subject to certain terms, warranties and exclusions which are available on request.

TILE TERMINATION AT DRAINAGE FLANGE WITH SOUNDPROOFING

DWG NO.

AWW-17

DATE

06.05.2019

SCALE

1 : 2 @ A4



SHOWER SIDE

SHOWER SCREEN BY OTHERS

SILICONE SEALANT BY OTHERS

ARDEX SE SILICONE

TILES

CONCRETE HOB

ARDEX X 18 ADHESIVE

ARDEX GROUT

ARDEX MEMBRANE WPM 155 OR
WPM 750

ARDEX A 38/A 48 SCREED

FLOOR SUBSTRATE

50 MM
OR EXTEND AS REQUIRED AS PER AS3740

WET AREA WATERPROOFING

ENCLOSED SHOWER WITH HOB
SHEET TITLE

DWG NO. AWW-18
DATE 06.05.2019
SCALE 1 : 2 @ A4



Disclaimer: Ardex makes every reasonable effort to ensure that the technical details, recommendations and other information contained in this drawing are accurate and represent our knowledge and experience at the time of design and publication. Ardex reserves the right to change the information without prior notice. Ardex provides the information in good faith with no representations or warranties (whether implied or otherwise), and will not be liable for any losses or damages (whether direct, indirect or consequential) whatsoever, whether in contract, negligence or any other action, arising out of or in connection with the use, or inability to use, the information. It is your responsibility to ensure that our products are used only for the purposes for which they are intended and are used in accordance with any applicable specifications, guidelines, standards, codes of practice, regulations and laws. The supply of our products and services are also subject to certain terms, warranties and exclusions which are available on request.

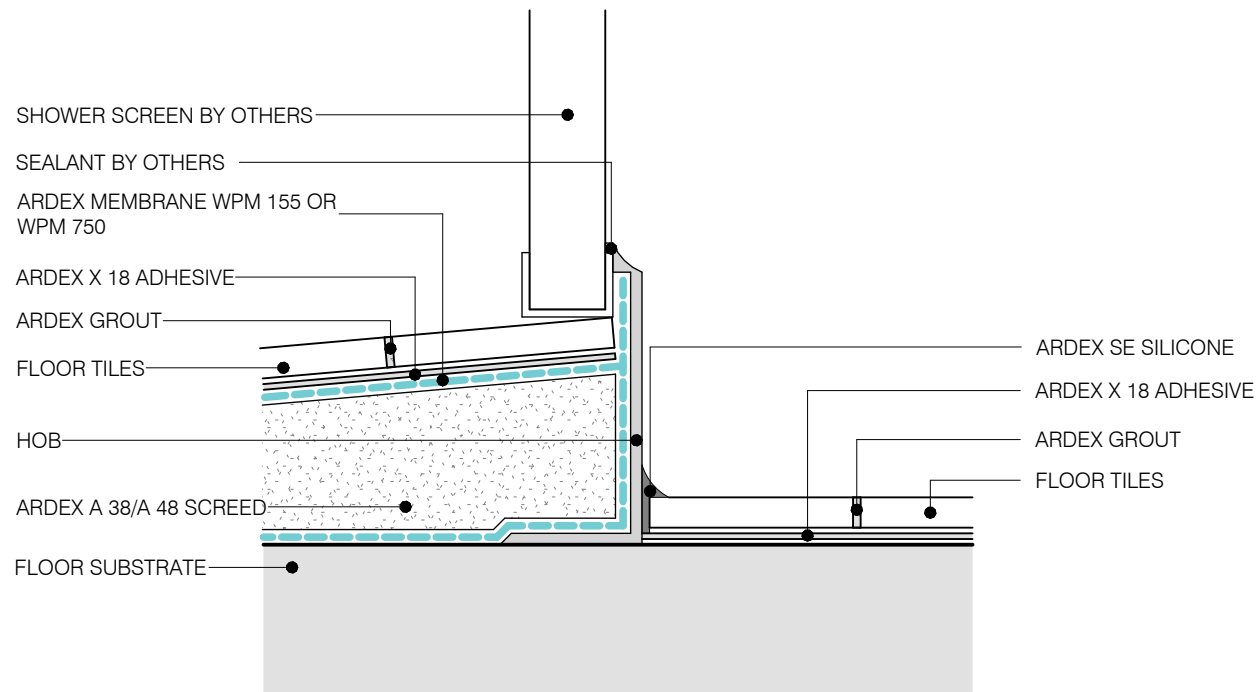

WET AREA WATERPROOFING

Disclaimer: Ardex makes every reasonable effort to ensure that the technical details, recommendations and other information contained in this drawing are accurate and represent our knowledge and experience at the time of design and publication. Ardex reserves the right to change the information without prior notice. Ardex provides the information in good faith with no representations or warranties (whether implied or otherwise), and will not be liable for any losses or damages (whether direct, indirect or consequential) whatsoever, whether in contract, negligence or any other action, arising out of or in connection with the use, or inability to use, the information. It is your responsibility to ensure that our products are used only for the purposes for which they are intended and are used in accordance with any applicable specifications, guidelines, standards, codes of practice, regulations and laws. The supply of our products and services are also subject to certain terms, warranties and exclusions which are available on request.

ENCLOSED SHOWER ON FLAT SUBSTRATE SHEET TITLE

DWG NO. **AWW-19**

DATE 06.05.2019
SCALE 1 : 2 @ A4



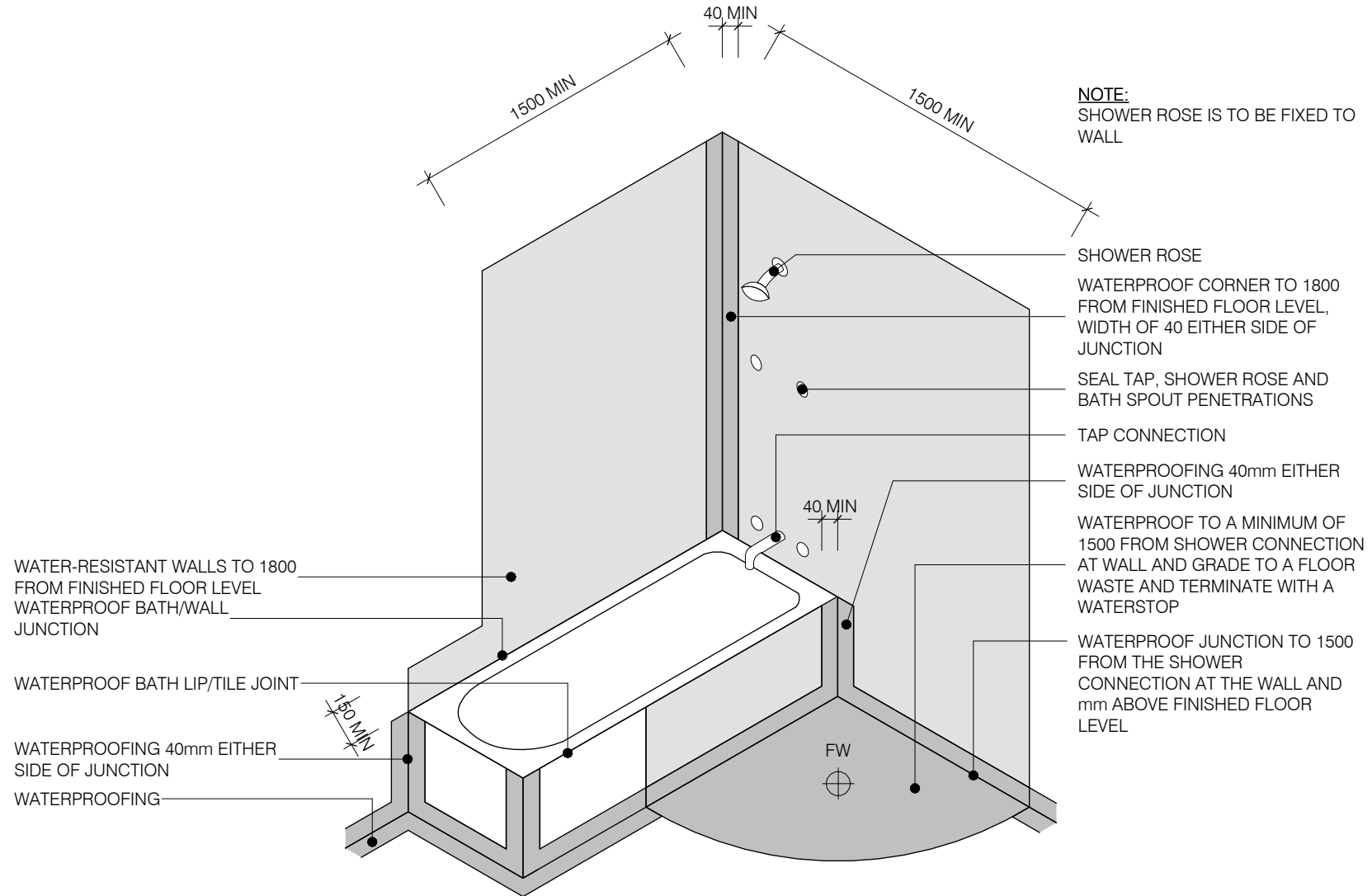

WET AREA WATERPROOFING

Disclaimer: Ardex makes every reasonable effort to ensure that the technical details, recommendations and other information contained in this drawing are accurate and represent our knowledge and experience at the time of design and publication. Ardex reserves the right to change the information without prior notice. Ardex provides the information in good faith with no representations or warranties (whether implied or otherwise), and will not be liable for any losses or damages (whether direct, indirect or consequential) whatsoever, whether in contract, negligence or any other action, arising out of or in connection with the use, or inability to use, the information. It is your responsibility to ensure that our products are used only for the purposes for which they are intended and are used in accordance with any applicable specifications, guidelines, standards, codes of practice, regulations and laws. The supply of our products and services are also subject to certain terms, warranties and exclusions which are available on request.

NO SHOWER PANEL
SHEET TITLE

DWG NO. **AWW-20**

DATE 06.05.2019

SCALE 1 : 2 @ A4



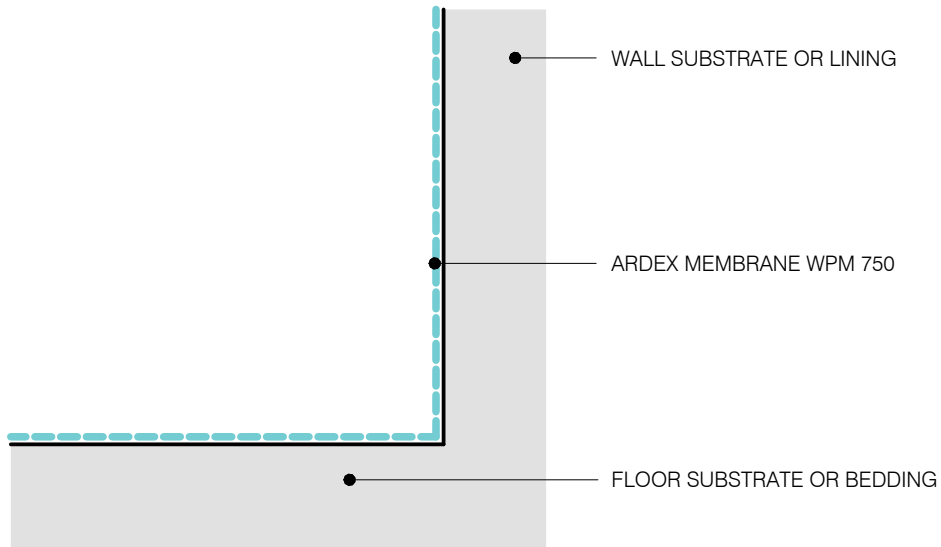

DETAIL 1

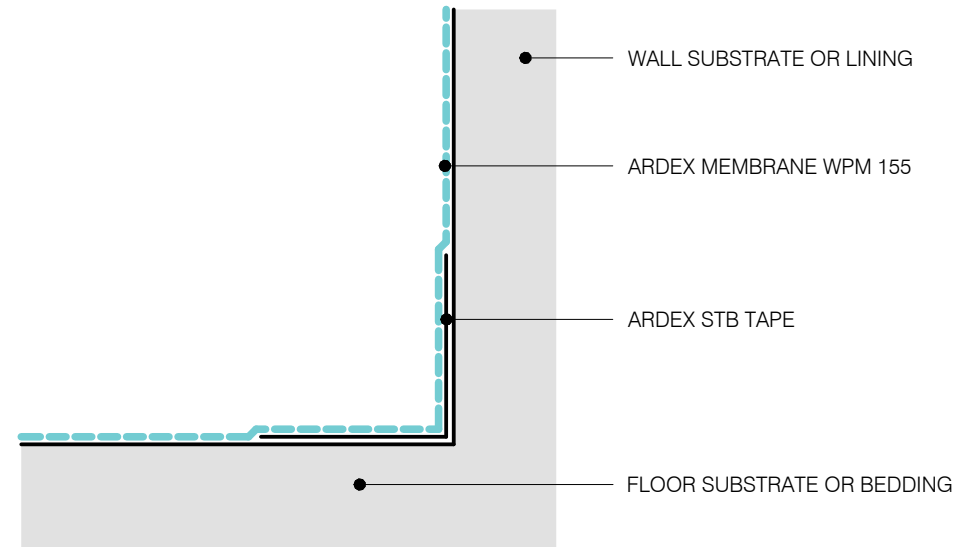

DETAIL 2

WET AREA WATERPROOFING

Disclaimer: Ardex makes every reasonable effort to ensure that the technical details, recommendations and other information contained in this drawing are accurate and represent our knowledge and experience at the time of design and publication. Ardex reserves the right to change the information without prior notice. Ardex provides the information in good faith with no representations or warranties (whether implied or otherwise), and will not be liable for any losses or damages (whether direct, indirect or consequential) whatsoever, whether in contract, negligence or any other action, arising out of or in connection with the use, or inability to use, the information. It is your responsibility to ensure that our products are used only for the purposes for which they are intended and are used in accordance with any applicable specifications, guidelines, standards, codes of practice, regulations and laws. The supply of our products and services are also subject to certain terms, warranties and exclusions which are available on request.

WALL/FLOOR DETAIL SHEET TITLE

DWG NO. **AWW-21**

DATE 06.05.2019

SCALE 1 : 2 @ A4



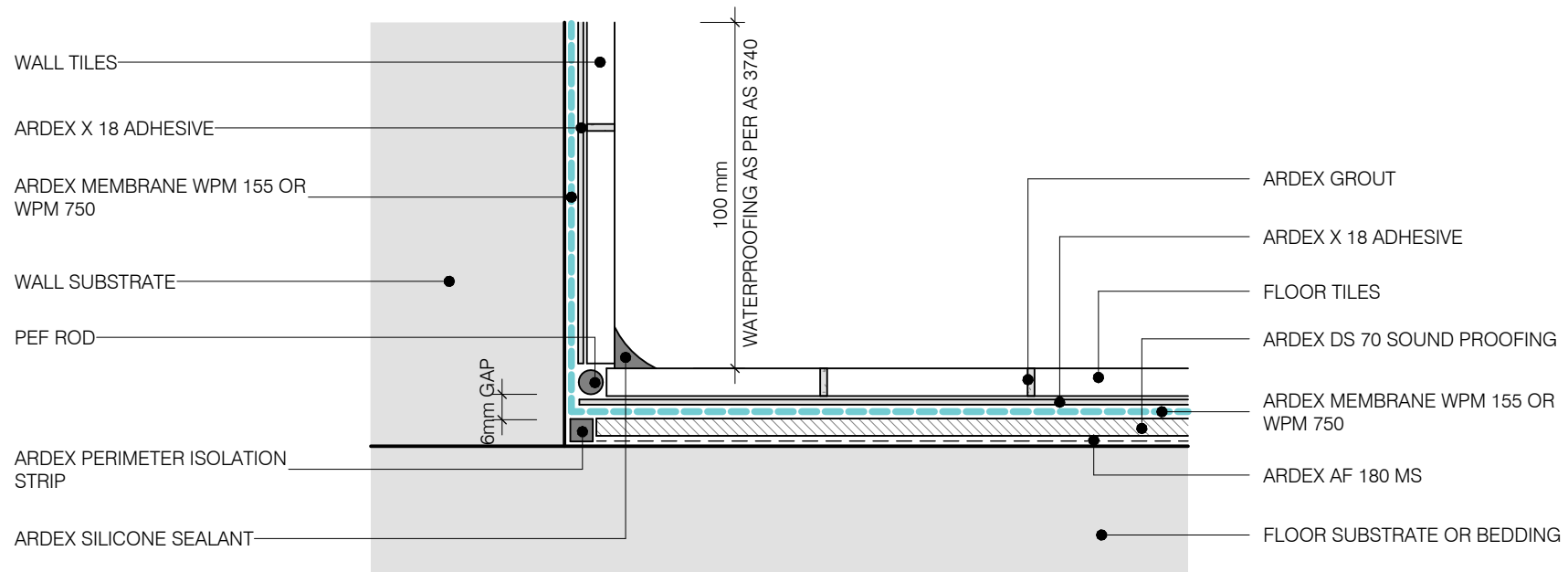

WET AREA WATERPROOFING

Disclaimer: Ardex makes every reasonable effort to ensure that the technical details, recommendations and other information contained in this drawing are accurate and represent our knowledge and experience at the time of design and publication. Ardex reserves the right to change the information without prior notice. Ardex provides the information in good faith with no representations or warranties (whether implied or otherwise), and will not be liable for any losses or damages (whether direct, indirect or consequential) whatsoever, whether in contract, negligence or any other action, arising out of or in connection with the use, or inability to use, the information. It is your responsibility to ensure that our products are used only for the purposes for which they are intended and are used in accordance with any applicable specifications, guidelines, standards, codes of practice, regulations and laws. The supply of our products and services are also subject to certain terms, warranties and exclusions which are available on request.

TILED FLOOR SOUNDPROOFING WITH WATERPROOFING

SHEET TITLE

DWG NO. **AWW-22**

DATE 06.05.2019

SCALE 1 : 2 @ A4



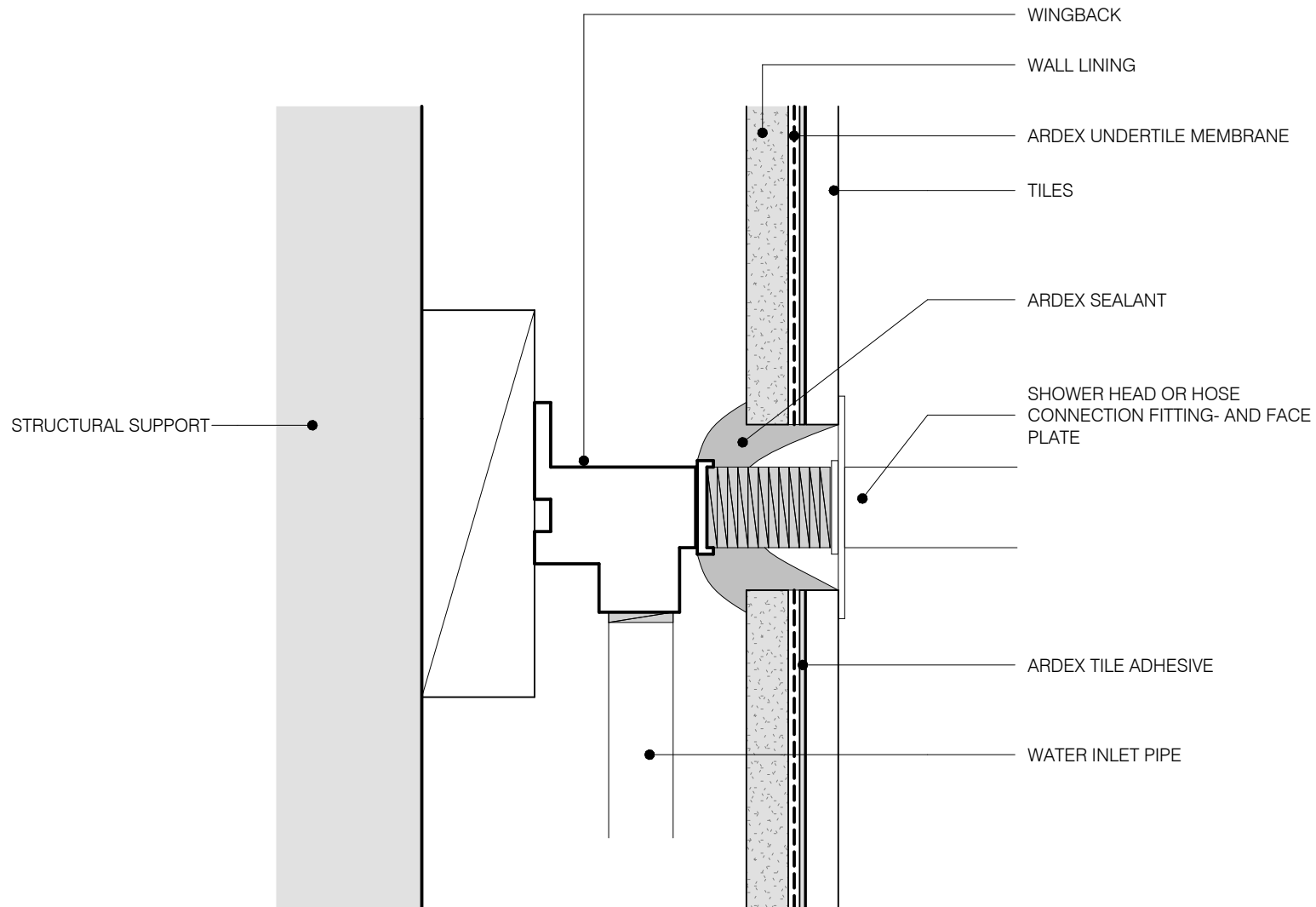

WET AREA WATERPROOFING

Disclaimer: Ardex makes every reasonable effort to ensure that the technical details, recommendations and other information contained in this drawing are accurate and represent our knowledge and experience at the time of design and publication. Ardex reserves the right to change the information without prior notice. Ardex provides the information in good faith with no representations or warranties (whether implied or otherwise), and will not be liable for any losses or damages (whether direct, indirect or consequential) whatsoever, whether in contract, negligence or any other action, arising out of or in connection with the use, or inability to use, the information. It is your responsibility to ensure that our products are used only for the purposes for which they are intended and are used in accordance with any applicable specifications, guidelines, standards, codes of practice, regulations and laws. The supply of our products and services are also subject to certain terms, warranties and exclusions which are available on request.

TYPICAL SHOWER HEAD OR FLEXIBLE HOSE CONNECTION

SHEET TITLE

DWG NO. **AWW-23**

DATE 12.07.2022

SCALE 1 : 2 @ A4



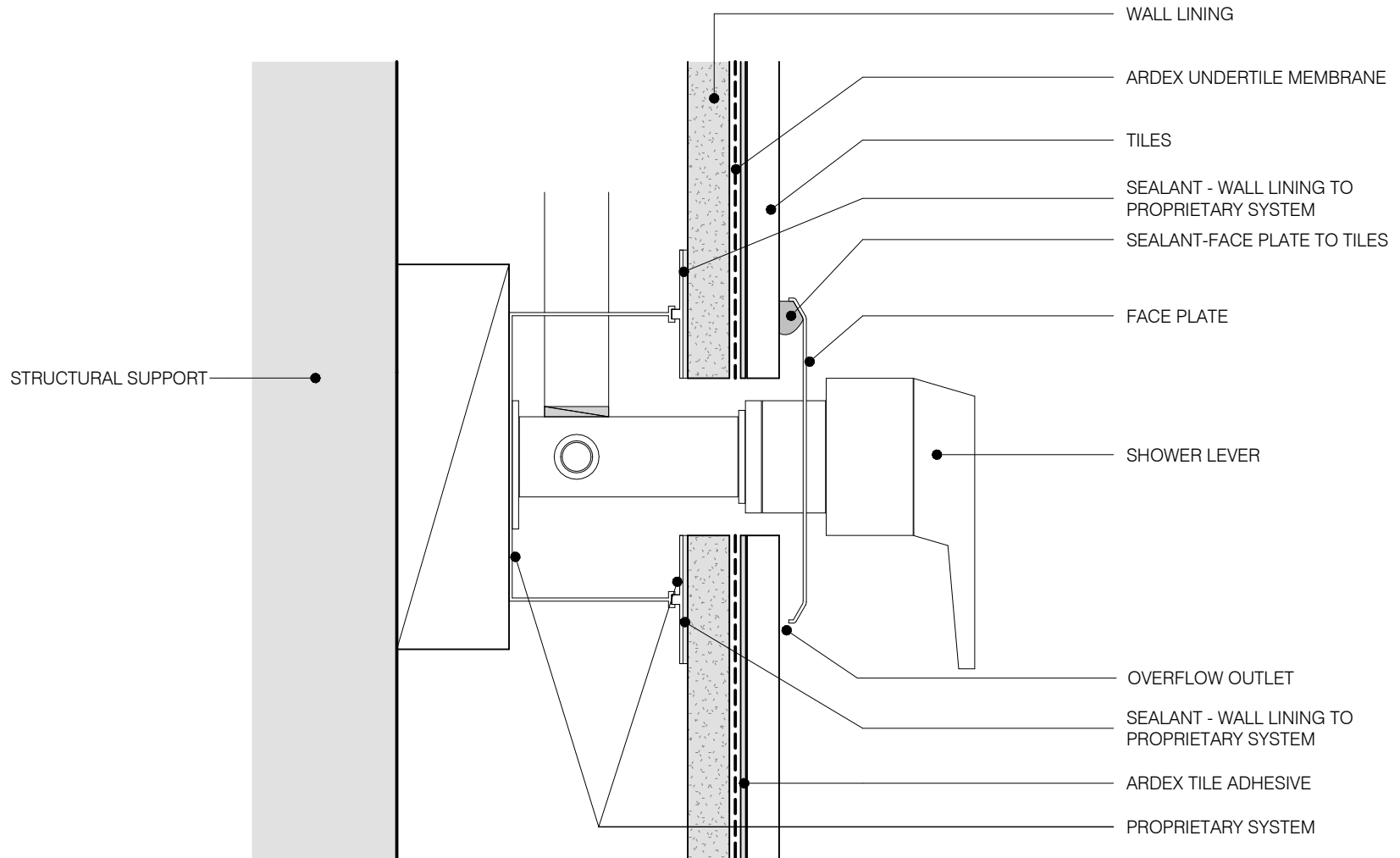

WET AREA WATERPROOFING

Disclaimer: Ardex makes every reasonable effort to ensure that the technical details, recommendations and other information contained in this drawing are accurate and represent our knowledge and experience at the time of design and publication. Ardex reserves the right to change the information without prior notice. Ardex provides the information in good faith with no representations or warranties (whether implied or otherwise), and will not be liable for any losses or damages (whether direct, indirect or consequential) whatsoever, whether in contract, negligence or any other action, arising out of or in connection with the use, or inability to use, the information. It is your responsibility to ensure that our products are used only for the purposes for which they are intended and are used in accordance with any applicable specifications, guidelines, standards, codes of practice, regulations and laws. The supply of our products and services are also subject to certain terms, warranties and exclusions which are available on request.

TYPICAL SHOWER MIXER USING PROPRIETARY SYSTEM

SHEET TITLE

DWG NO.

AWW-24

DATE

12.07.2022

SCALE

1 : 2 @ A4



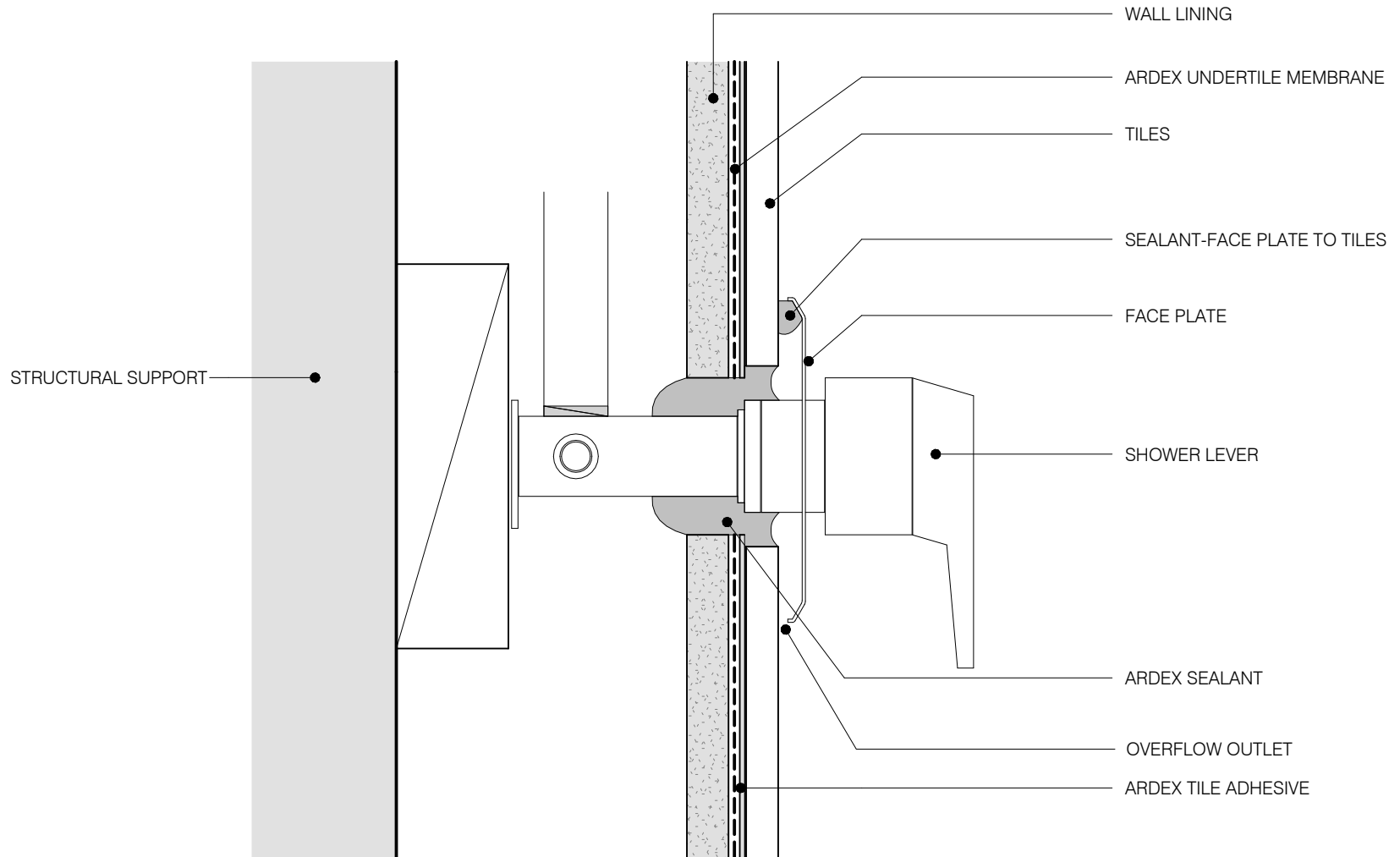

WET AREA WATERPROOFING

Disclaimer: Ardex makes every reasonable effort to ensure that the technical details, recommendations and other information contained in this drawing are accurate and represent our knowledge and experience at the time of design and publication. Ardex reserves the right to change the information without prior notice. Ardex provides the information in good faith with no representations or warranties (whether implied or otherwise), and will not be liable for any losses or damages (whether direct, indirect or consequential) whatsoever, whether in contract, negligence or any other action, arising out of or in connection with the use, or inability to use, the information. It is your responsibility to ensure that our products are used only for the purposes for which they are intended and are used in accordance with any applicable specifications, guidelines, standards, codes of practice, regulations and laws. The supply of our products and services are also subject to certain terms, warranties and exclusions which are available on request.

TYPICAL SHOWER MIXER USING SEALANT

SHEET TITLE

DWG NO.

AWW-25

DATE

12.07.2022

SCALE

1 : 2 @ A4

